

Installation Manual

Phanteks PH-TC14PE Thermal Radiator for Intel LGA 2011/1150/1155/1156/1366/775 and AMD FM2/FM1/AM3+/AM3/AM2+/AM2 (AMD stock backplate is required).

Thank you for purchasing a Phanteks Cooler. This manual will help guide you through the installation process of the PH-TC14PE.

Important! Before proceeding with this installation, please go to www.phanteks.com for the most up-to-date instructions. Multiple languages of this manual is available on our website. Supports & FAQ

For all inquiries concerning your Phanteks cooler, please contact our support team at support@phanteks.com. You can also refer to our FAQ section on our website www.phanteks.com for more information.

Common Required Mounting Parts

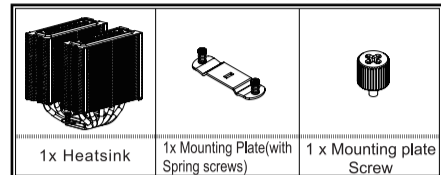

AMD Mounting Kit (Stock Backplate required)

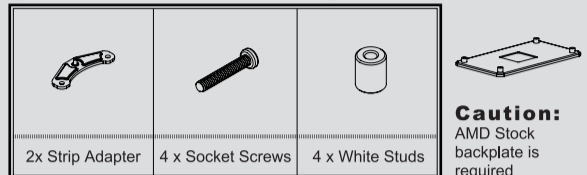

Intel LGA 2011 Mounting Parts

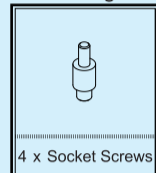

Intel LGA 1366/1150/1155/1156/775 Mounting Parts

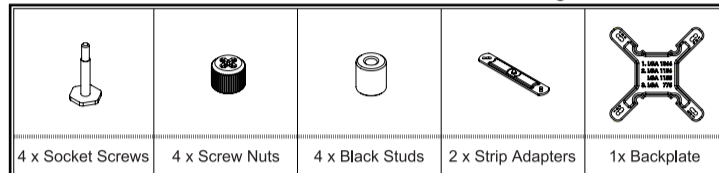

Delivered with PH-TC14PE

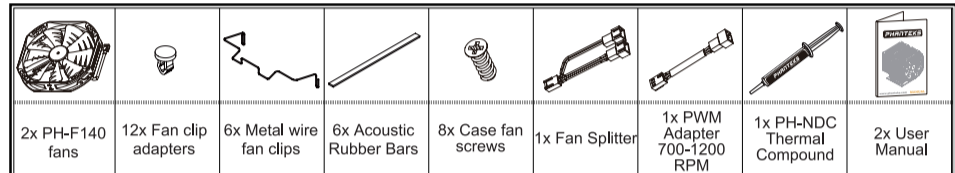

PH-TC14PE INTEL LGA 2011 Installation

Step 1: Installing the Intel 2011 Socket Screws to the mainboard

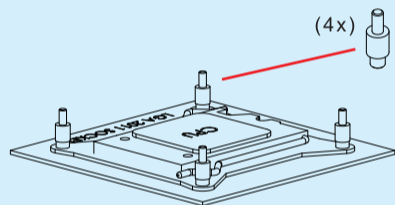

Insert the 4 socket screws directly into the mainboard.

Caution: *Continue on to Steps 4 - 13



PH-TC14PE AMD Installation

Step 1: Remove the retention module from the motherboard

If your motherboard has a retention module for stock CPU Cooler, please remove it first. Phanteks Solisku mounting bracket will install to your motherboard's stock backplate on the rear side of the socket.

Step 2: Attaching the Strip Adapter

First put the studs onto the screw holes then tighten the strip adaptor by using the 4 AMD socket screws. Tighten until the screws stop. Do not use force to overturn the screw.

Caution: *Continue to Steps 6-13.

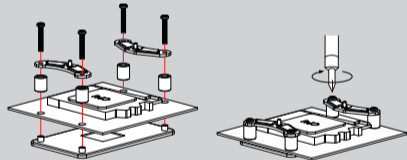

PH-TC14PE - LGA 775/1150/1155/1156/1366

Step 1: Remove the motherboard from the case.

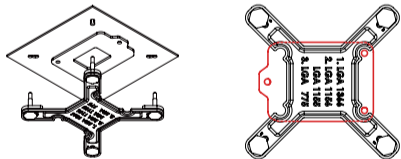

If you have no access to the back of motherboard the removal of motherboard is require to install the backplate.

Step 2: Setting up the backplate

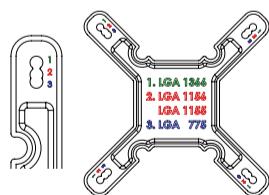

To install correctly, make sure you follow the socket position depending what socket you have.
Position 1 Intel LGA 2011/1366
Position 2 Intel LGA 1150/1155/1156
Position 3 Intel LGA 775

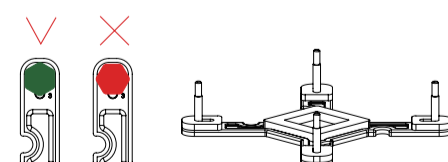
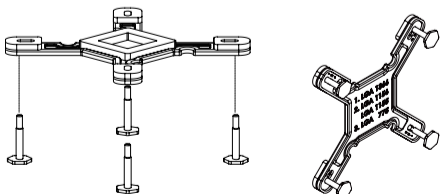

*Green = correct
*Red = incorrect
*Please verify that the four screws are inserted correctly.

Once you have the socket position, use the four screws provided and follow the diagram below.

Step 3: Installing the backplate

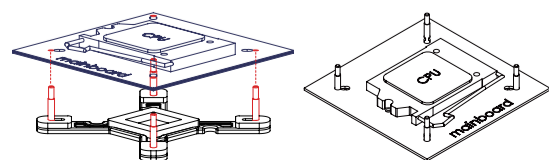

With the backplate set up and motherboard removed (if necessary), place the backplate over the back of the CPU mounting plate and insert it so that the screws are sticking through the socket mounting holes.

Step 4: Installing the studs and strip adapters

Put the (4x) black studs onto the socket screws.

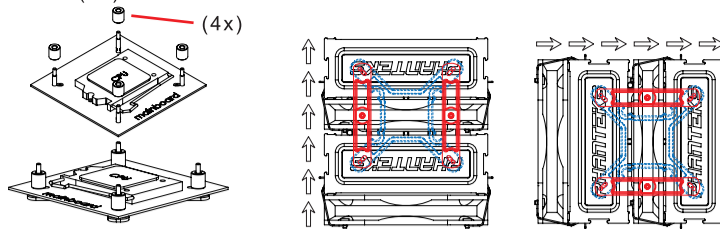

Place the strip adapters according to your desire placement of the cooler.

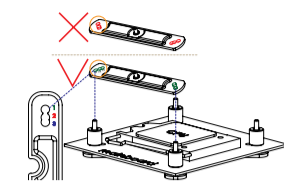

Make sure the direction of the strip adapter is installed correctly for both, position 3 being closest to the processor no matter what position you choose

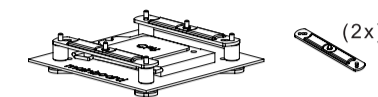

Position 3 being closest to the processor chip.

Step 5: Securing the strip adapter to the backplate

Tighten the screws. Do not overturn the screws.

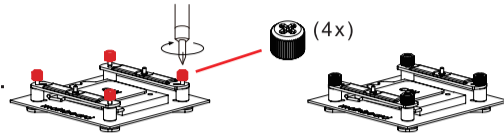

Step 6: Installing the SoliSku Mounting plate onto PH-TC14PE

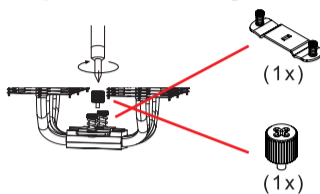

Place the mounting plate onto the aluminum base cover and use the screw to install it to the base cover.

Step 7: Installation of the PH-F140 fans

Insert the clip adapters into the 4 holes on each fan.

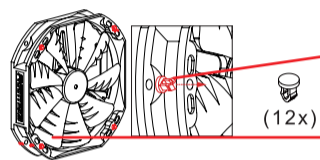

We provide you with 12 pcs of fan clip adapters for the optional 3rd fan. Each fan requires 4 clip adapters.

Clip adapter screw holes

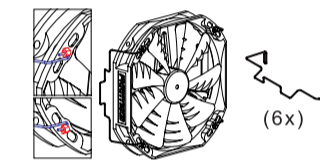

Insert the metal clip so that the pointed end of the metal clip is facing away from the fan.

Step 8: Sticking on the Rubber bars

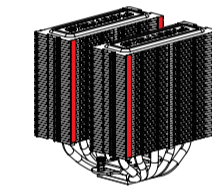

Place 4 rubber bars like shown in red highlighted area (zip point of the heatsink side area). 6pcs provided for optional 3rd fan.

Caution: Please do not stick the rubber bar onto any other positions on the heatsink, doing so will affect the convection efficiency.

Step 9: Attaching the fans to the heatsink

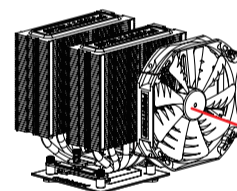

Use the two metal wire clips on the fan to firmly attach to the side of the heatsink. When done correctly the metal clip should be in the groove on the side of the heatsink.

Make sure the direction of the fan is like the one shown in diagram.

Step 10: Applying the thermal paste (PH-NDC)

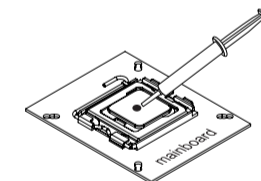

Before you apply PH-NDC, make sure you clean off any residual traces of thermal paste or thermal pads on your CPU. Then press a small drop (4-5mm diameter) of PH-NDC onto the center of the CPU surface.

Step 11: Mounting the heatsink to the CPU

Before you start, make sure the plastic protective cover on the base is taken off.

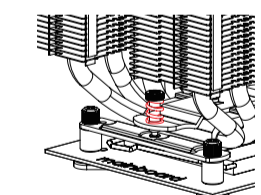

Place the heatsink on top of the CPU. Make sure the mounting plate screw is aligned with the strip adapter screw thread. Once aligned, screw it to the strip adapter.

Caution: Do not use force to overturn the screw.



Step 12: Installation of middle fan

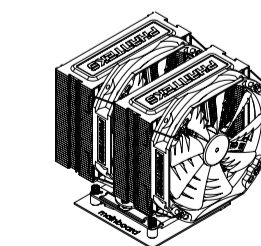

Insert the 2nd fan into the middle opening of the heatsink. Make sure not to force the fan in or the fins will be damaged. Use the metal wire clip to fasten to the side of the heatsink.

Step 13: Connecting the Heatsink fans to the motherboard

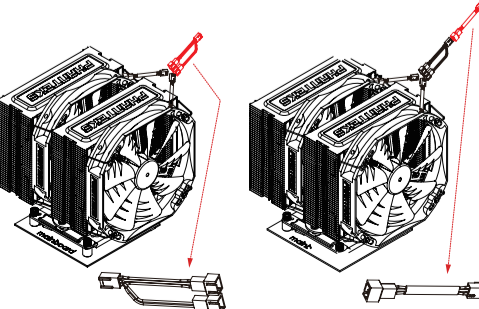

Plug the two fan cables to the Y-Splitter cable. Plug the single end of the fan splitter to the 3-pin end of the PWM adapter. Connect the PWM to the 4-pin on the motherboard.

*External PWM adapter will allow PH-F140 fans to adjust speed setting from 700-1200 RPM for silence to power performance.

*Required: You also need BIOS set for PWM control