

## Installation Manual

Phanteks PH-TC12DX Thermal radiator for INTEL LGA 2011 / 1156 / 1155/ 1366 / 775, AMD FM1/AM3+/AM3/AM2+/AM2 (AMD Stock backplate is required)

Thank you very much for choosing a Phanteks cooler. This manual will guide you through the installation process of the SoliSku mounting system step by step.

**Important!** Before proceeding with installation, please check for the most up-to-date instructions at [www.phanteks.com](http://www.phanteks.com). Multilingual versions of this manual are also available on our website.

### Supports & FAQ

For all enquiries concerning your Phanteks cooler, please contact the support team at [support@phanteks.com](mailto:support@phanteks.com). You can also consult the FAQ section on our website [www.phanteks.com](http://www.phanteks.com)

### Common required mounting parts:

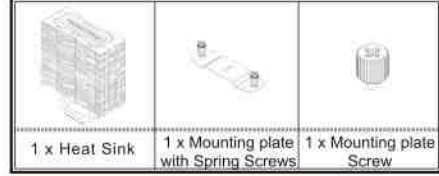

### Required mounting parts for AMD FM1/AM3+/AM3/AM2+/AM2

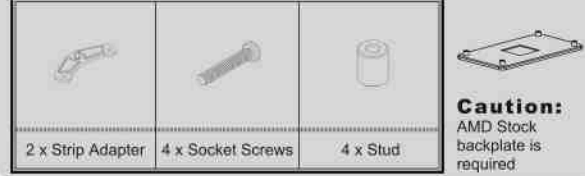

**Caution:** AMD Stock backplate is required

### Required mounting parts for INTEL LGA 2011



### Required mounting parts for INTEL LGA 1156/1155/1366/775

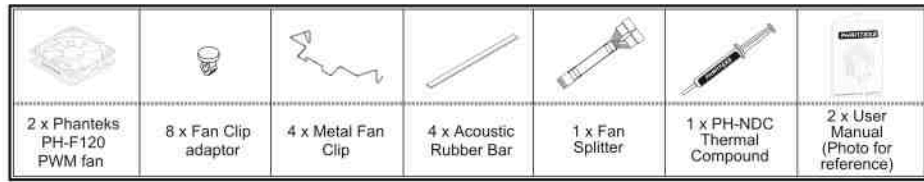
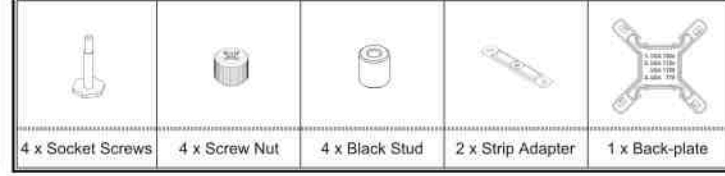

### PH-TC12DX INTEL LGA 2011 Installation Guide

**Step 1: Insert the 4 socket screws directly into mainboard.**

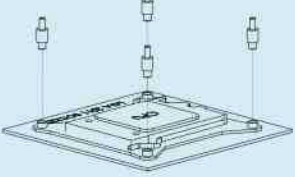

**Step 2: Set the strip adaptor on the socket screws.**

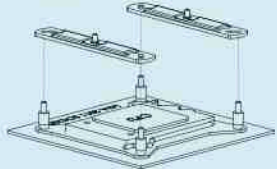

**Caution:** please refer to bracket position guide for this step.

**Step 3: for this step please refer to step 5.**

### PH-TC12DX AMD Installation Guide

**Step 1: Removing the retention module from motherboard**

If your motherboard has a retention module for stock CPU Cooler, please remove it first. Phanteks SoliSku mounting bracket will install to your motherboard's stock backplate on the rare side of the socket.

**Step 2: attaching the strip adaptor**

First put the studs onto the screw holes, then fix the strip adaptor by 4 AMD socket screws.

**Caution:** 1. Make sure the strip adaptor's direction is correct.  
2. Tighten the screws until stop.  
3. After finish AMD installation step 2, please skip and refer to **step 6**.

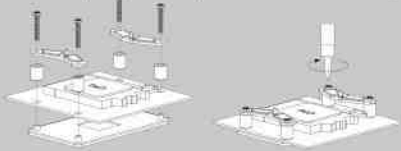

### PH-TC12DX INTEL Installation Guide

**Step 1: Removing the motherboard**

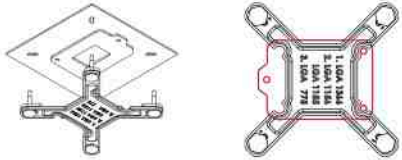

In order to use the Phanteks cooler in your system first you have to remove the motherboard from the case to install the backplate.

**Caution:** On LGA1366 and LGA1156/1155. Install the supplied backplate over the motherboard's stock backplate

**Step 2: Setting up the backplate**

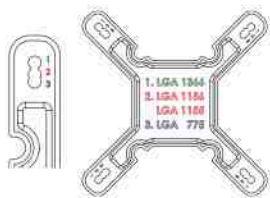

Apply each screw into the motherboard's INTEL CPU socket. (See Diagram below)

**Caution:** Please follow your socket position to put in the four socket screws as below.  
Position 1: INTEL LGA 2011/1366  
Position 2: INTEL LGA 1156/ LGA 1155  
Position 3: INTEL LGA 775

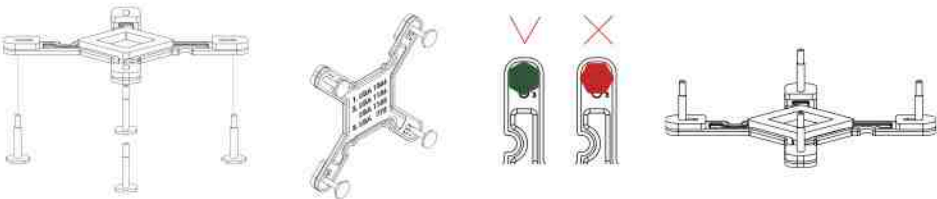

**Caution:** Please verify that all four socket screws are inserted correctly.

**Step 3: Securing the black-plate**

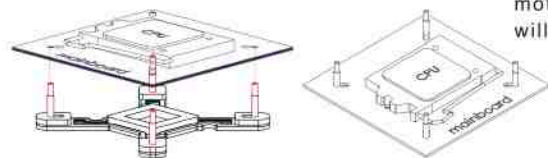

Place the backplate on the rear side of the motherboard properly, so that the socket screws will stick through the socket mounting holes.

**Step 4: Install the stud and strip adapters**

Place the four studs onto the socket screws.

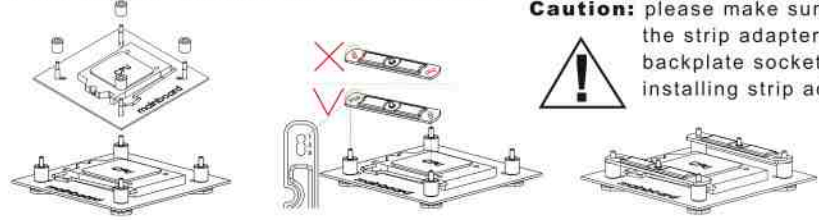

**Caution:** please make sure the socket hole of the strip adapters are correct following backplate socket hole to avoid wrong installing strip adapters.

**WRONG !!**

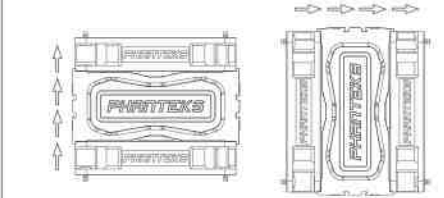
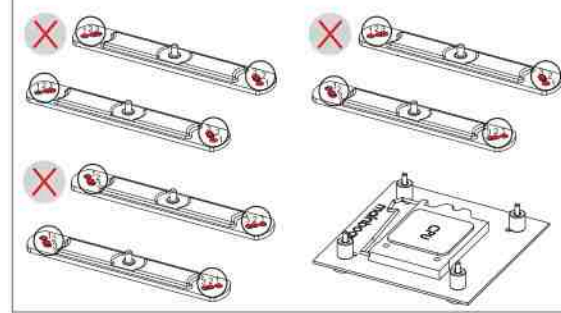

**Caution:** Choose the alignment of the INTEL mounting strip adapters according to your desired final orientation of the cooler:

**Step 5: Fixing the two mounting strip adapters**

**Caution:** Tighten the screws until stop.



**Step 6: Applying thermal paste**

If there are residual traces of thermal paste or thermal pads on your CPU, please clean them off first. Then press a small drop (4-5mm diameter) of Phanteks PH-NDC on the center of the CPU surface.

**Step 7: Fixed SoliSku mounting plate on PH-TC12DX**

Please put mounting plate onto cooler's alum. base cover and use mounting plate screw to fix the mounting plate.

**Caution:** Tighten the mounting plate screw until it stops.

**Step 8: Place the fan clip adaptors into screw holes and install the fan clip into the adaptor**

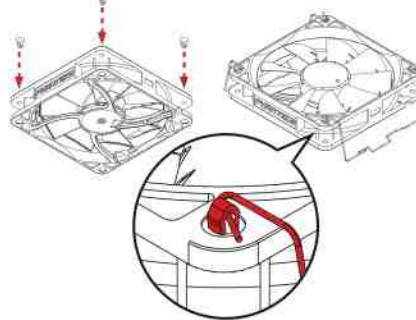

PH-TC12DX provides 8 pieces of fan clip adaptors, each fan requires 4 fan clip adaptors. Please put them into the 4 screw holes on each fan.

**Caution:** Please make sure the direction of the fan clip adaptors are correct. Refer to the image on the left.

**Step 9: Put on rubber bar onto heatsink**



Please do not stick rubber bar onto other position, it may block the fan airflow into the heatsink to affect the convection efficiency.

**Step 10: Place the heatsink on top of the CPU and secure the mounting plate**

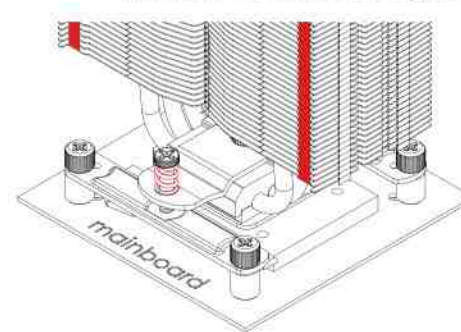

Please take off the protection cover at the bottom side of the heatsink first! Then put the heatsink on top of the CPU and screw it to the screw threads of the mounting plate.

**Caution:** Do not use force to overturn the screw, please stop when the screw is at a natural stop.

**Step 11: Attach the side fan to the heatsink**

Attach Phanteks PH-F120 fan with the metal wires fan clips.

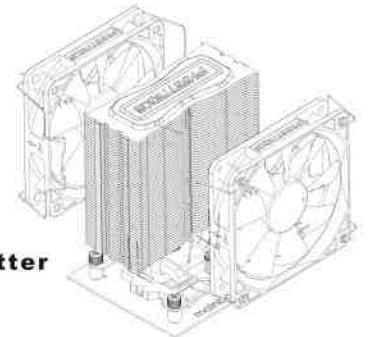

**Step 12: Hook the fan cable with Fan splitter**



Please connect the two fan's power cables to the FAN Splitter. Connect Fan Splitter to the motherboards CPU Fan header.

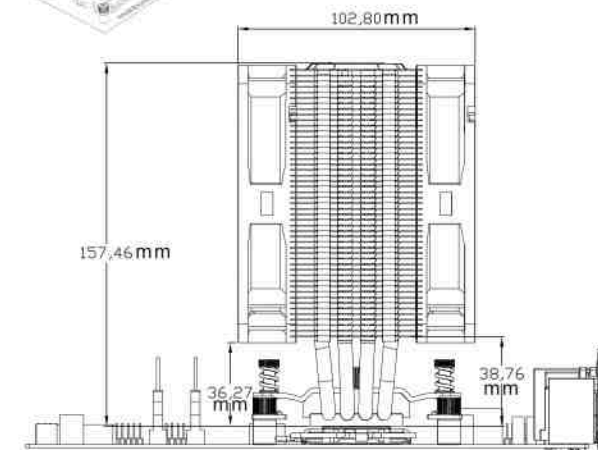

**Final image**

